



Wetrooms & Insulation



Product Catalogue
& Installation Guide

About us

Thermopanel Products

Established in 2003, Thermopanel is a member of the Pedarson Group, committed to creating high quality wet room components at an attractive price. We produce a wide range of wet room products, including: tile backer insulation boards, waterproofing, walk-in shower trays, drains, shower screens, underfloor heating and wet room accessories.

At Thermopanel we love a good-looking wet room and the brand was created from a desire to ensure that the growing trend for wet rooms is accessible to everyone. However, at Thermopanel we believe that it is what's underneath that truly counts. We encourage people to look beyond the facade and appreciate the importance of quality wet room foundations - because if it's not properly waterproofed then it's a damp room, not a wet room!

The benefits of installing a Thermopanel Wet Room Include....

✓ **100% WATERTIGHT**

The Thermopanel system provides a solid waterproof foundation which will eliminate leaks and water damage.

✓ **A COMPLETE WET ROOM SOLUTION**

Thermopanel produces all of the supplies and products needed to install a highly functional wet room.

✓ **CAN INCREASE PROPERTY VALUE**

Studies have shown that homes that add a wet room as a second bathroom are of a higher value than comparable homes with only a traditional bathroom.

✓ **DIFFERENTIATION**

Make your development stand out from competitors. Complete the look of the home and add prestige with a wet room installation.

✓ **QUALITY & VALUE**

Thermopanel produces high quality products created with the user in mind.

Contents

4	Tile Backer Board	24	XPS Niches
8	Square Drain Shower Trays	25	EPS Niches
16	Linear Drain Shower Trays	26	Pipe Boxes
22	Shower Tray for Vinyl Floor	27	Bath Panels



Create the backbone of your wet room with Thermopanel Tile Backer Boards

Thermopanel Tile Backer Insulation Boards are lightweight and easy to handle whilst providing superior waterproofing to your wet area. Available in a variety of sizes, they are incredibly versatile.

Thermopanel Tile Backer boards are specifically designed for two primary purposes -



As a first class heat insulation for underfloor heating systems.



As a superior waterproof surface to fix wall or floor tiles.

- Tile backer boards are particularly suited to underfloor heating mats and under tile heating cable applications.
- Will accept even the heaviest wall tiles, unlike plasterboard. (correct installation method must be followed)
- Installation below underfloor heating systems on an existing un-insulated concrete or timber sub-floor will greatly reduce heat up time and running costs.
- Our Boards will reduce the warm up time of the heating and reduce your electricity bill.
- Excellent heat insulation with thermal conductivity value of 0.027 W/mK making them ideal for use as a thermal barrier with under floor heating
- Ideal for wetrooms
- Tilebacker boards are waterproof and dimensionally stable (unlike plywood)
- Excellent sound insulation: impact sound is greatly reduced

Tile Backer Board / Construction Board

Description

Code	Length / Width / Thickness
TP06	1250 x 600 x 6mm
TP08	1250 x 600 x 8mm
TP10	1250 x 600 x 10mm
TP12	1250 x 600 x 12mm
TP15	1250 x 600 x 15mm
TP20	1250 x 600 x 20mm
TP30	1250 x 600 x 30mm
TP40	1250 x 600 x 40mm
TP50	1250 x 600 x 50mm



Wood Floor

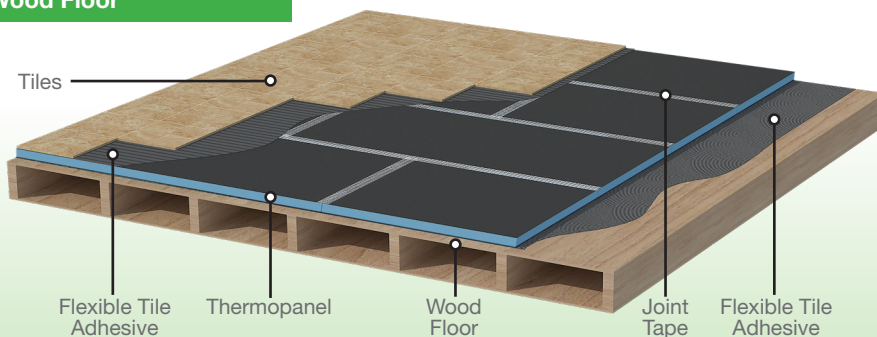

Concrete Floor

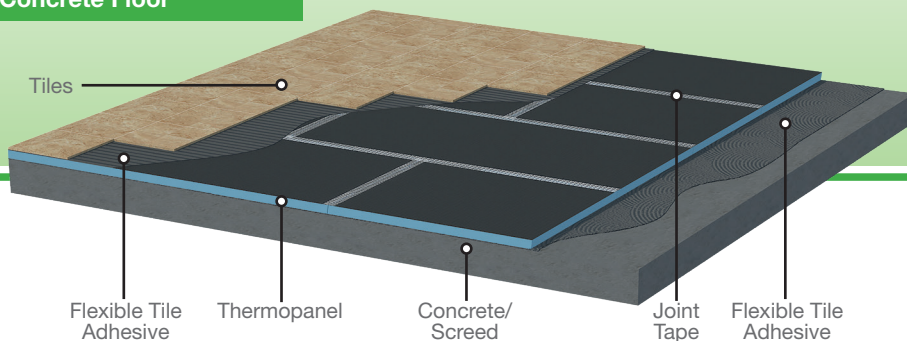

Installation Instructions For Tile Backer Boards

Timber Stud Walls

For walls made from stud, 10 or 12mm Thermopanel can be used for stud @ 300mm centres or 20mm Thermopanel if 600mm centres. Please ensure that all board edges are supported.



Fix Thermopanel to the studs using screws and Thermopanel washers (MSW36), the maximum spacing between fixings should be 300mm.



Solid Walls

Option 1 Screw Fixing

Measure the Thermopanel and cut to size utilising a sharp knife or saw.

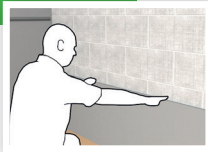

Wall plugs, screws and Thermopanel washers (MSW36) can be used at 300mm spacing to fix to a solid wall

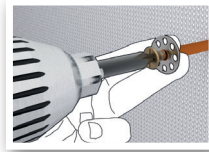

Solid Walls

Option 2 Tile Adhesive

A 5 to 8mm trowel is used to comb flexible tile adhesive over the whole surface of the Thermopanel.

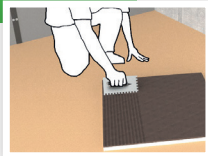

Stagger the Thermopanel brickwork fashion, pushing them firmly onto wall.



Solid Walls

Option 3 Drywall Fixing

Apply Thermopanel Drywall Foam (TPDF) to Thermopanel, firstly around perimeter, then at (approx.) 300mm centres. Application to the board laid flat with its end against the wall is generally the quickest method for application to solid walls.

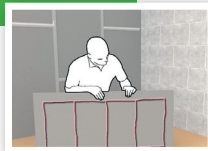

Allow the foam to cure for 4-5 minutes and then lever the board into position, then press firmly across the whole face of the board, starting at the top. Ensure the top and all edges receive as much pressure as the rest of the board.

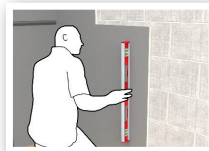

Preparation for Tiles or Plaster Tiling

All joints should be taped using Thermopanel Joint Scrim Tape (IJT90) with the exception of wet areas where Thermopanel butyl tape (Btape) should be used. The wall can now be tiled.



Plastering. Seal the edges of the boards using Thermopanel adhesive/sealant (Thermofix) before applying the Thermopanel scrim tape (IJT90). Plaster can now be applied.

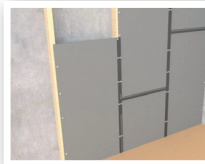

Floor Fixing Tile Adhesive

Use a 5-8mm trowel to apply a layer of flexible tile adhesive on to the base floor.

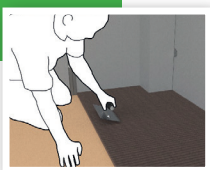

Place the Thermopanel down on the adhesive and push firmly down.



Floor Fixing Screws & Washers into Timber

Measure the Thermopanel and cut to size utilising a sharp knife or saw. Lay Thermopanel in the desired position.



Use screws and Thermopanel washers (MSW36) to fix the boards every 300mm to the wooden subfloor.

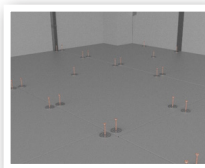

If further waterproofing is required, use Thermopanel adhesive / sealant (Thermofix) to seal the joints. Alternatively, in really wet areas use Thermopanel Butyl Tape (Btape)

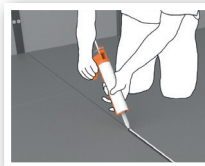

Square Drain Shower Tray Assembly Information

THERMOPANEL

Shower tray kit consists of a shower tray and a drainage system. Both components are coordinated with each other and form one unit.

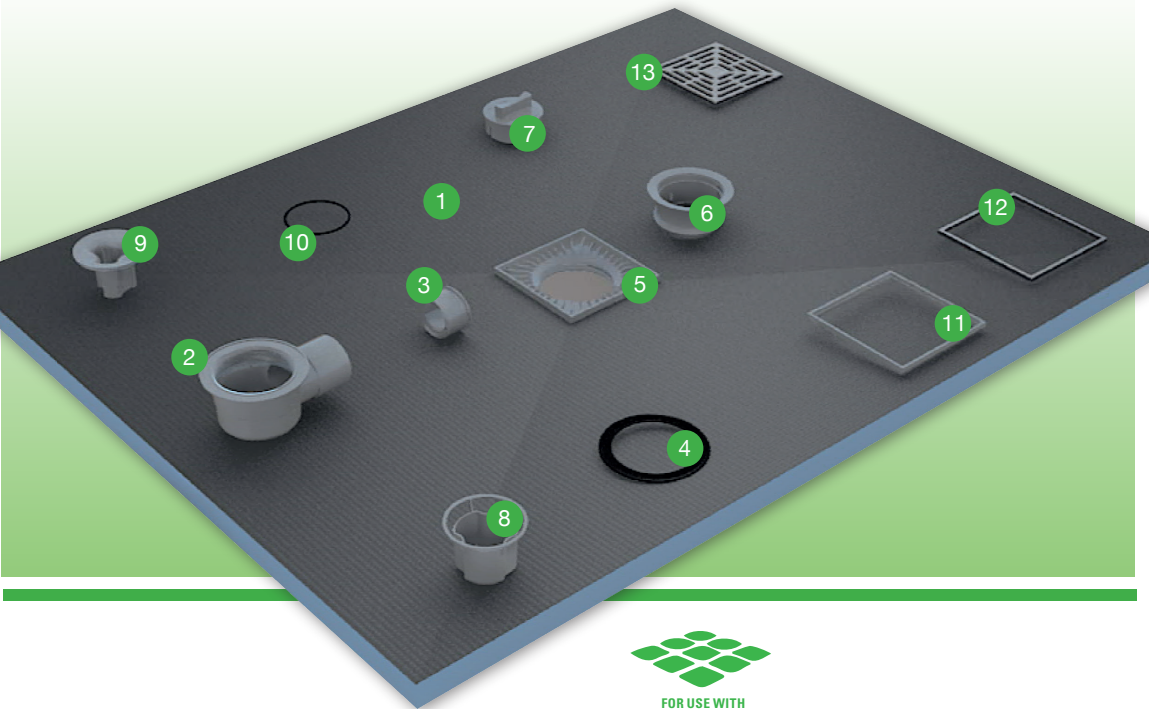

System components

- | | | |
|-------------------|-------------------|-------------------------|
| 1 Shower tray | 6 Connection | 11 Riser Piece |
| 2 Drain body | 7 Key | 12 Stainless Steel Edge |
| 3 50-40mm Reducer | 8 Drain Basket | 13 Grate |
| 4 Rubber O-Ring | 9 Inlet with seal | |
| 5 Plastic Support | 10 O-Ring | |

Specifications

Size	Central			Offset			Corner		
	Thickness (mm)								
	20	25	30	20	25	30	20	25	30
800 x 800									
900 x 900									
1000 x 1000									
1200 x 800									
1200 x 900									
1200 x 1000									
1200 x 1200									
1300 x 900									
1400 x 900									
1500 x 900									
1500 x 800									
1800 x 900									



NOTE:

Each side of the shower tray can be trimmed up to 50mm

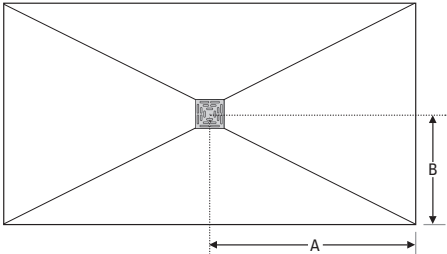

Position:Centre drain: A=1/2 length B=1/2 width

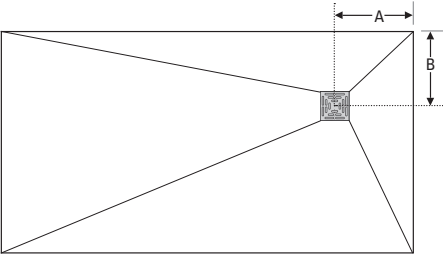

Normal Position:Corner drain: A=B=260mm

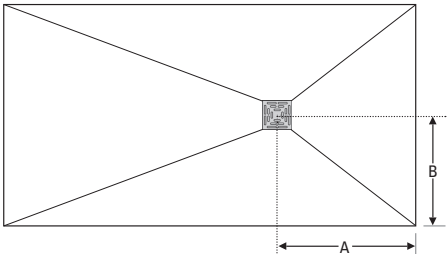

Normal Position:Offset drain: A=450mm B=1/2 width

Square Drain Shower Trays



Specifications

Part number	Description
SF0808CEN	800 x 800 x 20mm Square Shower Tray with Centre Drain
SF0808COR	800 x 800 x 20mm Square Shower Tray with Corner Drain
SF0909CEN	900 x 900 x 20mm Square Shower Tray with Centre Drain
SF0909COR	900 x 900 x 20mm Square Shower Tray with Corner Drain
SF1010CEN	1000 x 1000 x 20mm Square Shower Tray with Centre Drain
SF1010COR	1000 x 1000 x 20mm Square Shower Tray with Corner Drain
SF1010OFF	1000 x 1000 x 20mm Square Shower Tray with Offset Drain
SF1208CEN	1200 x 800 x 20mm Rectangular Shower Tray with Centre Drain
SF1208COR	1200 x 800 x 20mm Rectangular Shower Tray with Corner Drain
SF1208COR-R	1200 x 800 x 20mm Rectangular Shower Tray with Corner Drain (Right)
SF1208OFF	1200 x 800 x 20mm Rectangular Shower Tray with Offset Drain
SF1209CEN	1200 x 900 x 20mm Rectangular Shower Tray with Centre Drain
SF1209COR	1200 x 900 x 20mm Rectangular Shower Tray with Corner Drain
SF1209COR-R	1200 x 900 x 20mm Rectangular Shower Tray with Corner Drain (Right)
SF1209OFF	1200 x 900 x 20mm Rectangular Shower Tray with Offset Drain
SF1210CEN	1200 x 1000 x 20mm Rectangular Shower Tray with Centre Drain
SF1210COR	1200 x 1000 x 20mm Rectangular Shower Tray with Corner Drain
SF1210COR-R	1200 x 1000 x 20mm Rectangular Shower Tray with Corner Drain (Right)
SF1210OFF	1200 x 1000 x 20mm Rectangular Shower Tray with Offset Drain
SF1212CEN	1200 x 1200 x 20mm Square Shower Tray with Centre Drain
SF1212COR	1200 x 1200 x 20mm Square Shower Tray with Corner Drain
SF1212OFF	1200 x 1200 x 20mm Square Shower Tray with Offset Drain
SF1309CEN	1300 x 900 x 25mm Square Shower Tray with Centre Drain
SF1309COR	1300 x 900 x 25mm Square Shower Tray with Corner Drain
SF1309OFF	1300 x 900 x 25mm Square Shower Tray with Offset Drain
SF1409CEN	1400 x 1900x 25mm Square Shower Tray with Centre Drain
SF1409COR	1400 x 1900x 25mm Square Shower Tray with Corner Drain
SF1409OFF	1400 x 1900x 25mm Square Shower Tray with Offset Drain
SF1508CEN	1500 x 800 x 25mm Rectangular Shower Tray with Centre Drain
SF1508OFF	1500 x 800 x 25mm Rectangular Shower Tray with Offset Drain
SF1509CEN	1500 x 900 x 25mm Rectangular Shower Tray with Centre Drain
SF1509OFF	1500 x 900 x 25mm Rectangular Shower Tray with Offset Drain
SF1809CEN	1800 x 900 x 25mm Rectangular Shower Tray with Centre Drain
SF1809OFF	1800 x 900 x 25mm Rectangular Shower Tray with Offset Drain
SFDRAIN	Square Drain

Installation Instructions For Square Drain Shower Tray

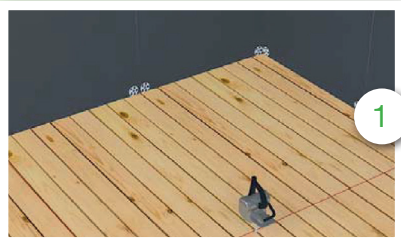

1

Put shower tray in the correct position and mark around the tray, to establish which section of the floor boards needs to be removed, the tray can be recessed.

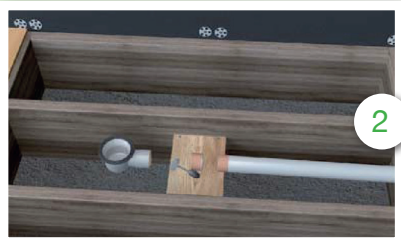

2

Once the floorboards are removed, Measure and mark where your drain and waste pipe will be fitted.

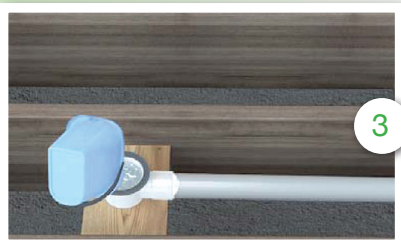

3

Cut a piece of plywood to support the drain for drain body, this should be 10mm higher than waste pipe. Connect the drain body to the waste pipe with solvent weld in the usual way. (Always check for leaks before final installation of shower tray).



4

Fix a batten below the top of the joists.

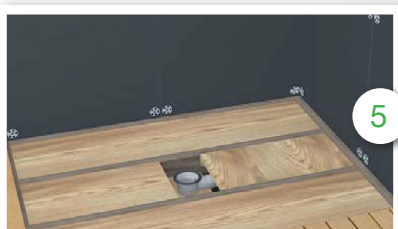

5

Once you are satisfied with the drainage, place plywood around the drain and fix in position.



6

Spread the adhesive evenly over the area where the shower tray is to be installed, being careful to clean away any adhesive on the rim of the trap.



7

Ensure that the surface is smooth & Level.

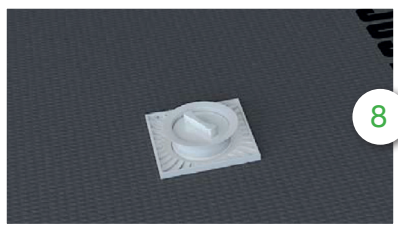

8

Fix the shower tray into position. With a spirit level, check that the edges of the tray are level. Also you should use waterproof tape to connect all joint and wall corners.

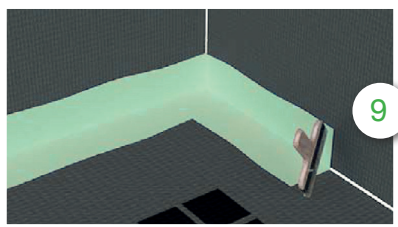

9

Seal all joints (both wall and floor) utilising special waterproof membrane / paste.

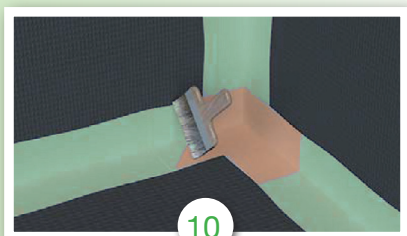

10

Seal all corners of shower area with inside corner membrane / paste.



11

Then set the O-ring on Inlet with Seal and put it in.

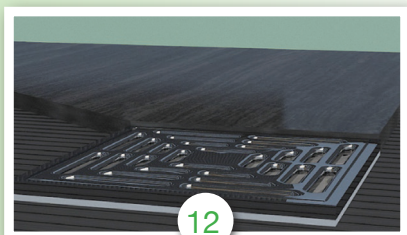

12

If there's height difference between tile and drain.

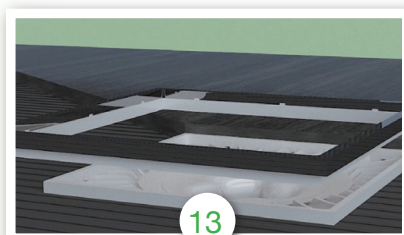

13

Use the riser piece to balance the height difference between tile and drain.



14

The shower base is finished and can be tiled.

Tips: In principle, you can use all types and sizes of tiles, special requirements for tiles and mosaic thickness to be <25mm, and the size of the tiles and mosaic on the shower tray must be =50 * 50mm. Otherwise, you should consult the manufacturer.

Installation Section Detail For Wooden Framework

Mokra Shower Tray Kit - Installation Height

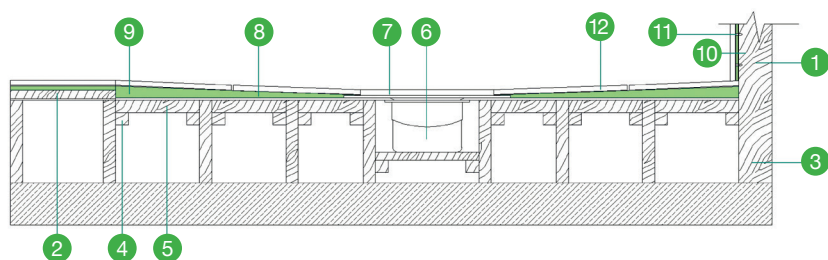

- | | | |
|----------------------------|--|-----------------------------|
| 1 Wooden wall construction | 7 Stainless steel grate | 10 Backer board (6/10/20mm) |
| 2 Floor board 18mm | 8 Shower tray | 11 Washer and screw |
| 3 Floor joist | 9 Sealing tape or Waterproofing membrane | 12 Tiles |
| 4 Support for ply board | | |
| 5 Ply board 18mm | | |
| 6 Shower drain body | | |

Installation Section Detail For Concrete Floor

Mokra Shower Tray Kit - Installation Height

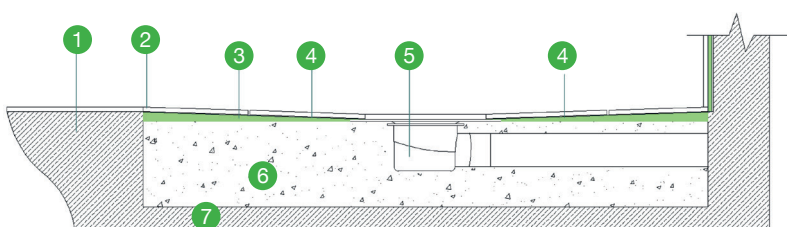

- | | | |
|---------------------------|---------------|--------------------|
| 1 Screed | 4 Slope | 6 Levelling screed |
| 2 Waterproof sealing tape | 5 Floor drain | 7 Concrete floor |
| 3 Shower tray | | |

Linear Drain Shower Tray Assembly Information



Linear shower tray kit consists of a shower tray and a drainage system. Both components are coordinated with each other and form one unit.

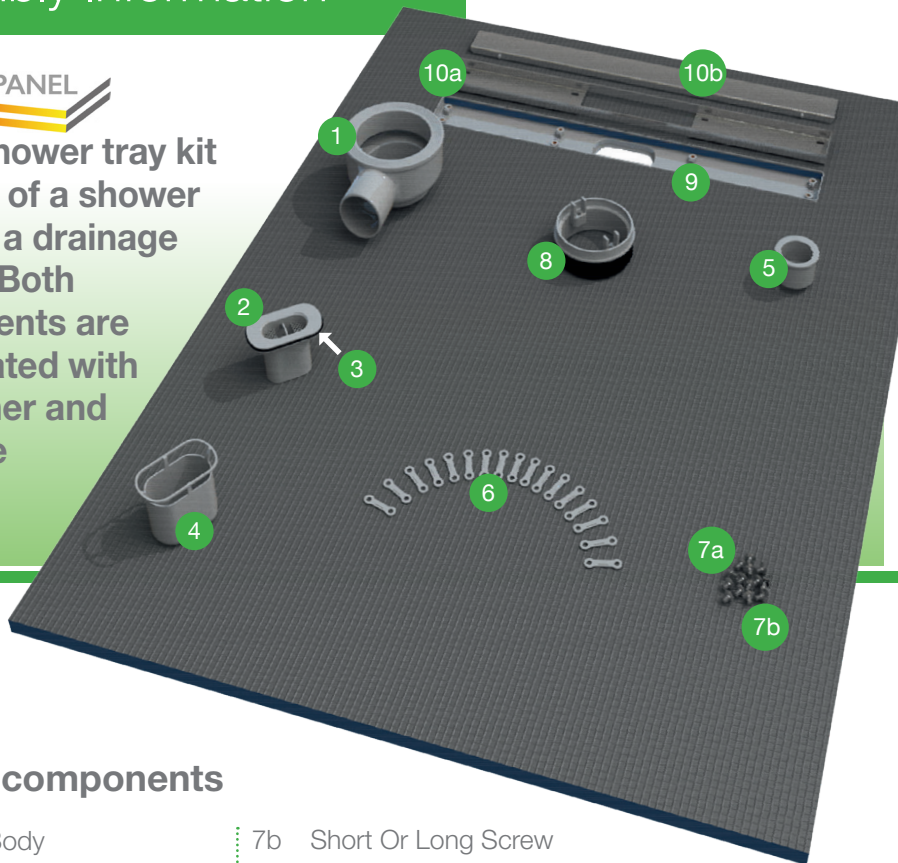

System components

- | | | | |
|----|-------------------------|-----|------------------------------------|
| 1 | Drain Body | 7b | Short Or Long Screw |
| 2 | Dip-tube | | For Height Adjustment Spacer |
| 3 | O Ring | | (Please use these screws according |
| 4 | Drain Basket | | to your requirement) |
| 5 | 50-40mm Reducer | 8 | Connection |
| 6 | Height Adjustment | 9 | Plastic support 600mm length |
| | Spacer (thickness1.5mm) | 10a | Stainless Steel Support |
| 7a | Screw For Connection | | 600mm length. |
| | (M5.5*29mm) | 10b | Stainless Steel Grate |
| | | | 600mm length |

Specifications

Part number	Description
SF0909LIN	900 x 900 x 30mm Square Shower Tray with Linear Drain
SF1010LIN	1000 x 1000 x 30mm Square Shower Tray with Linear Drain
SF1209LIN	1200 x 900 x 30mm Rectangular Shower Tray with Linear Drain
SF1212LIN	1200 x 1200 x 30mm Square Shower Tray with Linear Drain
SF1509LIN	1500 x 900 x 30mm Rectangular Shower Tray with Linear Drain
SF1809LIN	1800 x 900 x 30mm Rectangular Shower Tray with Linear Drain
SF1209LIN90	1200 x 900 x 30mm Rectangular Shower Tray with Linear Drain (side)
SF1509LIN90	1500 x 900 x 30mm Rectangular Shower Tray with Linear Drain (side)
SF1809LIN90	1800 x 900 x 30mm Rectangular Shower Tray with Linear Drain (side)
SFLG01	Linear Shower Grate - Slots
SFLG05	Linear Shower Grate - Wavy
SFLG08	Linear Shower Grate - Crest
SFLG12	Linear Shower Grate - Droplets
SFLG15	Linear Shower Grate - Greek
SFLG16	Linear Shower Grate - Stars
SFLT01	Linear Shower Grate - Tile
SFLT02	Linear Shower Grate - Solid
SFLD	Linear Shower Drain

Available sizes

Part no	Dimensions					
	X	Y	A	B	C	D
SF1209LIN90	1200	900	600	300	200	70
SF1509LIN90	1500	900	600	450	200	70
SF1809LIN90	1800	900	600	600	200	70

Part no	Dimensions					
	X	Y	A	B	C	D
SF0909LIN	900	900	600	150	200	70
SF1010LIN	1000	1000	600	150	200	70
SF1209LIN	1200	900	600	150	200	70
SF1212LIN	1200	1200	600	600	200	70
SF1509LIN	1500	900	600	150	200	70
SF1809LIN	1800	900	600	150	200	70

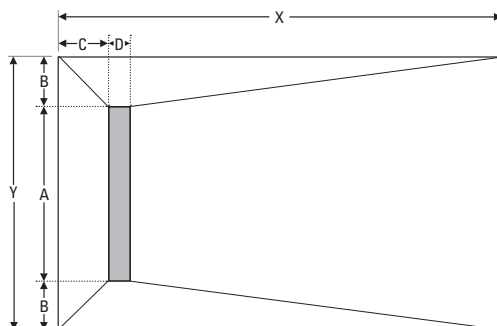
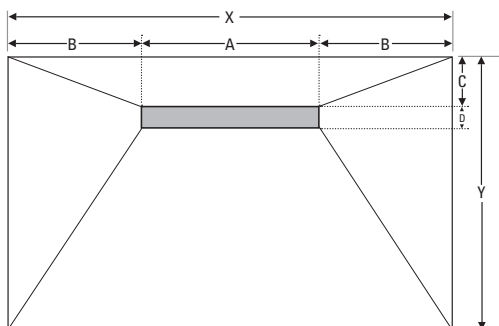

Installation Instructions For Linear Shower Tray

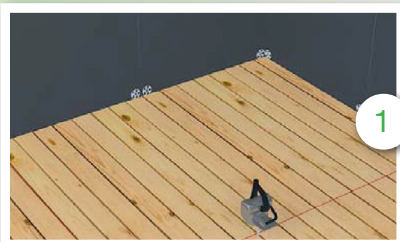

Put shower tray in the correct position and mark around the tray, to establish which section of the floor boards need to be removed, the tray can be recessed.

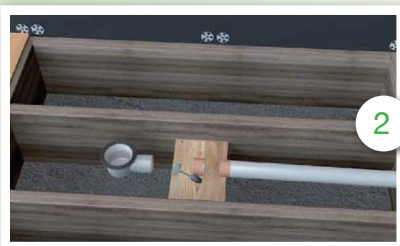

Once the floorboards are removed, Measure and mark where your drain and waste pipe will be fitted.

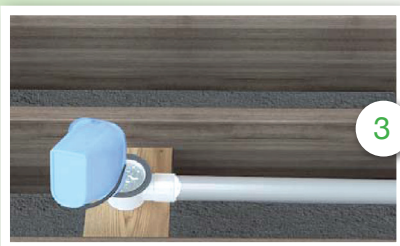

Cut a piece of plywood to support the drain for drain body, this should be 10mm higher than waste pipe. Connect the drain body to the waste pipe with solvent weld in the usual way. (Always check for leaks before final installation of shower tray).



Fix a batten below the top of the joists.



5

Once you are satisfied with the drainage, place plywood around the drain and fix in position.



6

Spread the adhesive evenly over the area where the shower tray is to be installed, being careful to clean away any adhesive on the rim of the trap.



7

Ensure that the surface is smooth & Level.

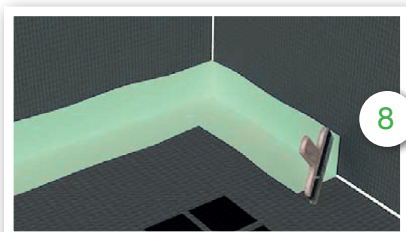

8

Seal all joints (both wall and floor) utilising special waterproof membrane / paste.

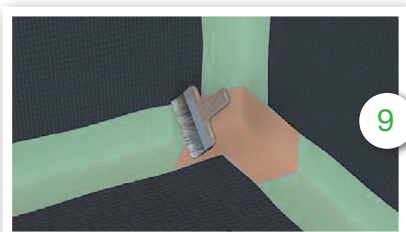

9

Seal all corners of shower area with inside corner membrane / paste.

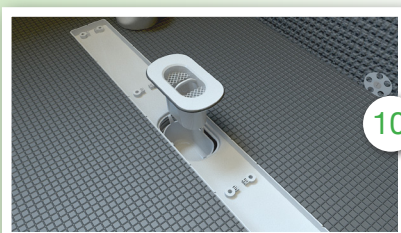

10

Assemble other drain components

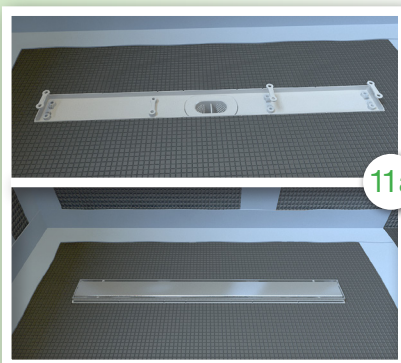

11a

If you're not using a tile on grate, adjust the height of the stainless steel support utilising the height adjustment spacers, each space will increase the height by 1.5mm. Depending on the number of spacers used, use either the long or short screws to fix the stainless steel support to the tray

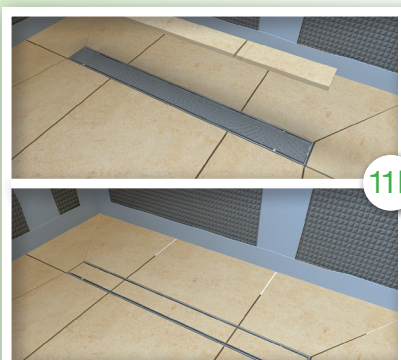

11b

If you're using a tile on grate, the height of the stainless steel support can be adjusted utilising the height adjustment spacers, but the inner height of the tile on the grate is fixed (13mm). Please ensure that you use suitable tiles for the grate and the shower tray.



12

The shower base is now finished and can be tiled.

Installation Section Detail For Wooden Floor

Mokra Linear Shower Tray

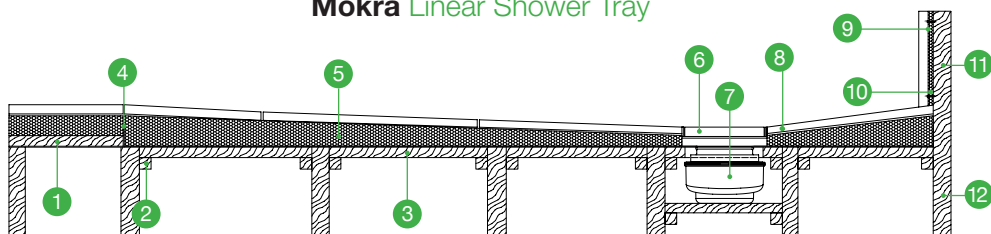

- | | | |
|-------------------------|------------------------------|-----------------------------|
| 1 Floor board 18mm | 6 Stainless steel grate | 11 Wooden wall construction |
| 2 Support for PLY board | 7 Linear Shower drain body | 12 Floor joist |
| 3 PLY board 18mm | 8 Tile | |
| 4 Waterproof paint | 9 Washer and screw | |
| 5 Linear shower tray | 10 backer board (10/12/20mm) | |

Installation Section Detail For Concrete Floor

Mokra Linear Shower Tray

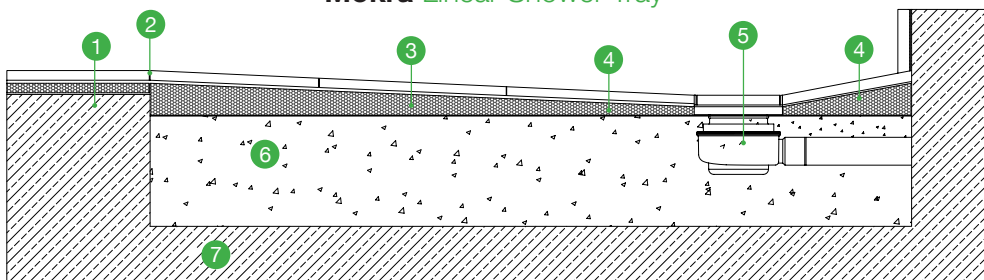

- | | |
|--------------------|----------------------------|
| 1 Screed | 5 Linear Shower drain body |
| 2 Waterproof paint | 6 Levelling screed |
| 3 Shower tray | 7 Concrete floor |
| 4 Slope | |

Showerdec

Showerdec is affordable, strong and available in a wide range of size options.

Showerdec is highly adaptable and means that every home can enjoy the superior style and luxury that a wet room provides.

Constructed using the SMC process from a combination of resin and fibreglass to form a strong and consistent floor former, it is strong enough to fit straight onto joists, saving time and money.



FOR USE WITH VINYL FLOOR COVERINGS

Features

- Manufactured using the SMC process from a combination of resin and fibreglass to form a strong and consistent floor former.
- Super strong single piece construction
- Fixes straight onto joists saving time and money
- 20-year guarantee for peace of mind

Available sizes

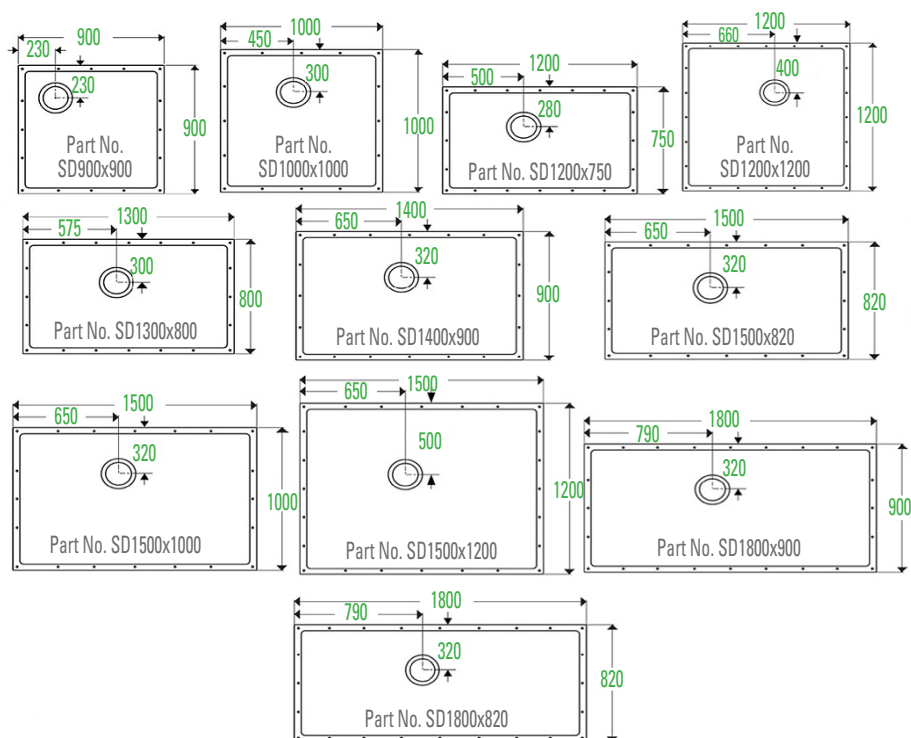

Features

- GRP composition
- Trimmable for extra versatility
- 20-year guarantee
- Load capacity of up to 100 stone/635kg
- Suitable for wooden and solid floors
- 11 sizes c/w waste
- Fixes onto joists – no underboarding

Part Number	Description	Width (mm)	Length (mm)
SD900X900	900 x 900 Showerdec Tray	900	900
SD1000X1000	1000 x 1000 Showerdec Tray	1000	1000
SD1200X1200	1200 x 1200 Showerdec Tray	1200	1200
SD1200X750	1200 x 750 Showerdec Tray	1200	750
SD1300X800	1300 x 800 Showerdec Tray	1300	800
SD1400X900	1400 x 900 Showerdec Tray	1400	900
SD1500X1000	1500 x 1000 Showerdec Tray	1500	1000
SD1500X1200	1500 x 1200 Showerdec Tray	1500	1200
SD1500X820	1500 x 820 Showerdec Tray	1500	820
SD1800X820	1800 x 820 Showerdec Tray	1800	820
SD1800X900	1800 x 900 Showerdec Tray	1800	900

CTW01	Vinyl Flooring Gravity Waste for Showerdec Trays
TSG52-S	Tiled Flooring Gravity Waste for Showerdec Trays

Thermopanel Shower Niches

Thermopanel Shower Niches are low cost, easily installed and completely waterproof. Designed to provide extra space for small shower items.

They comprise of an extruded polystyrene core coated on either side with a thin robust layer of fibreglass reinforced polymer concrete and coated with a waterproof membrane paint.

Thermopanel Shower Niches are fixed to a timber frame, so that the front of the Niche are flush with the Thermopanel construction boards on the wall. The joints between the Niche and the construction boards are sealed together with Waterproof Tape.

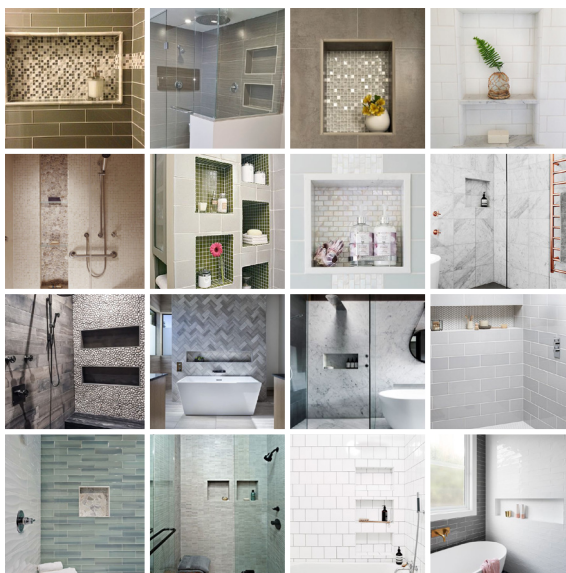

Features

- Completely waterproof.
- Provides thermal insulation.
- Ready to tile.
- Lightweight and easy to work with.
- Made with 12.5mm thick board and fit wall cavities 100mm or deeper
- Comes already constructed which guarantees the conformity and the size

Part Number	Description	Width (mm)	Height (mm)	Depth (mm)
TPN350240	Tileable Shower Niche	350	240	100
TPN350350	Tileable Shower Niche	350	350	100
TPN350420	Tileable Shower Niche	350	420	100
TPN900250	Tileable Shower Niche	900	250	100

Shower Niches

Thermopanel EPS Niche is constructed of lightweight high-density expanded polystyrene with a waterproof finish and ready to tile. They are lightweight, durable and are not a food source for fungus and mold.

Thermopanel EPS fabricated niches are a one piece construction and waterproof. Guaranteed to never rot, degrade or leak. Their insulative factor does not promote condensation in the wall cavity. The perfect fit for all your shower necessities, our niches install quickly and safely and integrate flush into the wall panel assembly.

Features

- Lightweight & durable
- Easy to transport, handle and adjust during insulation
- Installed in minutes
- Waterproof and ready to tile
- Multiple design options and sizes available added utility and value to the shower

Part Number	Description	Width (mm)	Height (mm)	Depth (mm)	Internal (mm)
TPN235235F	Tileable Shower Niche	235	235	100	200x200
TPN360360F	Tileable Shower Niche	360	360	100	300x300
TPN360565F	Tileable Shower Niche	360	565	100	300x510
TPN235565F/2	Tileable Shower Niche	235	565	100	200x150 + 200x300
TPN360565F/2	Tileable Shower Niche	360	565	100	300x150 + 300x300



Thermopanel Pipe Boxing



The Solution to Hide Unsightly Pipework

Specially designed to enable easy, fast and clean boxing-in of exposed pipe work. The Thermopanel pipe Boxings are completely waterproof so they are suitable for shower and wet rooms, as well as bath.

The Pre-fabricated boards are 20 mm thick. Made from 100% HCFC-FREE XPS hard foam, reinforced with fibreglass mesh on both sides and coated with polymer-modified mortar. The boards are 100% waterproof and remain fully functional.

Thermopanel shaped Angle Board can simply cover the water pipes and other attachment by flexible tile adhesive. Its cemented surface is a good adhesive undersurface for tiling. The easy installation can save a lot of time and money.

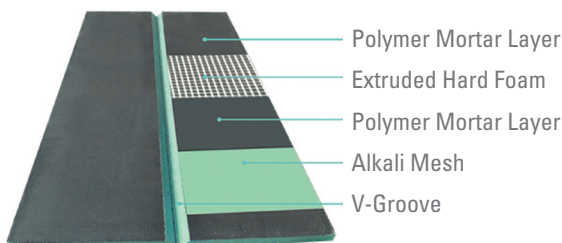

Features

- Can be either tiled or plastered
- Fast and efficient way to box in pipes prior to tiling or plastering
- Greatly reduces installation time
- Provides a much better tiling surface than timber
- Reduces the need to plasterboard timber when applying render
- Waterproof and stable in a moist environment
- Can be used to create designs in a bathroom rather than simply covering unsightly features
- Easy and cost effective method for creating tiled columns and rounded corners panels.

Part Number	Description	Thickness (mm)	Width (mm)	Height (mm)	Depth (mm)
TP150	Pipe Boxing Panel – 'L'	20	150	150	1250
TP200	Pipe Boxing Panel – 'L'	20	200	200	1250
TP300	Pipe Boxing Panel – 'L'	20	300	300	1250

Bath Panels

Perfect for tiling around your bath with tiles matching the walls and/or floor, Thermopanel bath panels offer the best solution.

The panels just need to be cut to the correct length, positioned and height adjusted using the integral feet. You're now ready to tile!

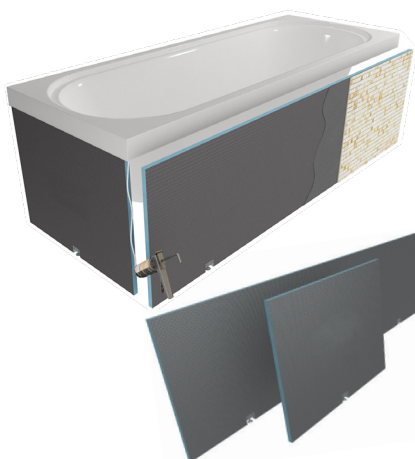

Part Number	Description	Length (mm)	Width (mm)	Depth (mm)
TPBP1	Tileable Side Bath Panel with 2 adjustable Feet	2100	600	30
TPBP2	Tileable End Bath Panel with 2 adjustable Foot	1850	600	30
TPBP3	Tileable Bath Panel with 1 adjustable foot	770	600	30

Thermopanel Curved Boards

Thermopanel Pre-Slit Curved Boards are the perfect solution for the fast creation of curved walls, curved bathroom panels, moulded tiled seats and P-shaped baths.

The boards are exceptionally easy to work with, easy to cut and shape with excellent tile adhesion and waterproofing properties.

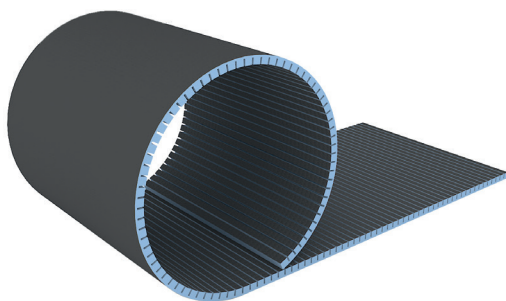

Part Number	Description	Length (mm)	Width(mm)	Depth (mm)
TP20CB	Curved Construction board	1250	600	20

PIII Waterproofing Tapes, Corners, etc



Part No.	Description	Length (mm)	Width (mm)
ISOTAPE5	5m PIII Membrane Tape	5m	100mm
ISOTAPE10	10m PIII Membrane Tape	10m	100mm
ISOTAPE50	50m PIII Membrane Tape	50m	100mm



Part No.	Description
ISO-COR-INT	Waterproof Membrane internal corner
ISO-COR-EXT	Waterproof Membrane External corner

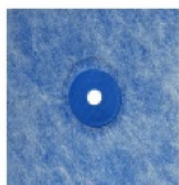

Part No.	Description	Pipe Dia (mm)	Length (mm)	Width (mm)
ISO-COLLAR-16	Waterproof Membrane Pipe Collar	16	120mm - Diameter	
ISO-COLLAR-12	Waterproof Membrane Pipe Collar	12-42	120mm	120mm
ISO-COLLAR-25	Waterproof Membrane Pipe Collar	25-36	150mm	150mm
ISO-COLLAR-75	Waterproof Membrane Pipe Collar	75-150	250mm	250mm

Waterproofing/ Membranes(Paste)



Part No.	Description	Size
ISOTANK1.5	Isolbau Waterproofing / Tanking Membrane	1.5Kg
ISOTANK4		4Kg

PIII Waterproofing Tapes, Corners, etc

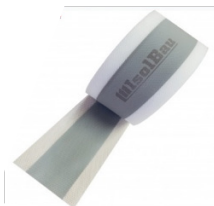

Part No.	Description	Length	Width
VJT5	VODA Waterproof Joint Tape 5m	5m	100mm
VJT10	VODA Waterproof Joint Tape 10m	10m	100mm
VJT50	VODA Waterproof Joint Tape 50m	50m	100mm



Part No.	Description
VWCI	VODA Waterproof Corner Internal
VWCE	VODA Waterproof Corner External

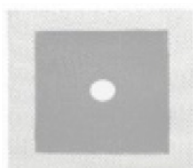

Part No.	Description	Pipe Dia (mm)	Length	Width
VWC1/2	VODA Waterproof Collar 1/2" (120x120mm)	1/2"	120mm	120mm
VWC18	VODA Waterproof Collar 18-20mm (120x120mm)	18-20	120mm	120mm



Adhesive / Sealant

Part No.	Description	Size
Thermofix	Solvent Free Adhesive and Sealant	290ml



Primer

Part No.	Description	Size
ISO-GR1	Acrylic-Polymer Solvent Free Primer	1 Litre
ISO-TFPR01	Siliceous-Polymer Solvent Free Primer	1 Litre

PIII Waterproofing Tapes, Corners, etc



Part No.	Description	Length	Width
BT5	Butyl Waterproof Reinforcement Tape (Self Adhesive)	5m	100mm
BT10	Butyl Waterproof Reinforcement Tape (Self Adhesive)	10m	100mm
BT20	Butyl Waterproof Reinforcement Tape (Self Adhesive)	20m	100mm

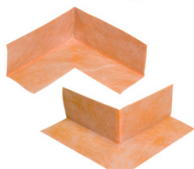

Part No.	Description
B-INT	Butyl Waterproof Internal Corner (Self Adhesive)
B-EXT	Butyl Waterproof External Corner (Self Adhesive)



Part No.	Description	Length	Width
BM5	Butyl Waterproofing Membrane 1m x 5m (Self Adhesive)	5m	1m
BM10	Butyl Waterproofing Membrane 1m x 10m (Self Adhesive)	10m	1m



Part No.	Description	Size
BRS300	Premium Butyl Rubber Sealant	300ml

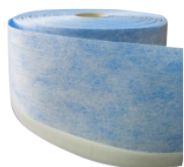

Part No.	Description	Length	Width
SBT2	Self Adhesive Butyl Waterproof Joint Tape for Baths & Showers	2m	120mm
SBT3	Self Adhesive Butyl Waterproof Joint Tape for Baths & Showers	3m	120mm
SBT4	Self Adhesive Butyl Waterproof Joint Tape for Baths & Showers	4m	120mm
SBT25	Self Adhesive Butyl Waterproof Joint Tape for Baths & Showers	25m	120mm

PIII Waterproofing Tapes, Corners, etc



Part No.	Description
IS02/1.5	1.5 Kg Isolbau Waterproofing / Tanking Membrane 1L Polymer Solvent Free Primer 5m PII Membrane Tape 1No. PII Waterproof Internal Corners



IS02/4	4 Kg Isolbau Waterproofing / Tanking Membrane 1L Polymer Solvent Free Primer 10m PII Membrane Tape 2No. PII Waterproof Internal Corners
--------	--



IS03/1.5	1.5 Kg Isolbau Waterproofing / Tanking Membrane 1L Polymer Solvent Free Primer 5m PIII Membrane Tape 1No. PIII Waterproof Internal Corners
----------	---



IS03/4	4 Kg Isolbau Waterproofing / Tanking Membrane 1L Polymer Solvent Free Primer 10m PIII Membrane Tape 2No. PIII Waterproof Internal Corners
--------	--



Butyl5	5m x 1 m Butyl Waterproofing Membrane (Self Adhesive) 5m x 100mm Butyl Waterproof Reinforcement Tape (Self Adhesive) 2No. Butyl Waterproof Internal Corner (Self Adhesive) Premium Butyl Rubber Sealant (300ml) 1L Polymer Solvent Free Primer
--------	--



Butyl10	10m x 1 m Butyl Waterproofing Membrane (Self Adhesive) 10m x 100mm Butyl Waterproof Reinforcement Tape (Self Adhesive) 4No. Butyl Waterproof Internal Corner (Self Adhesive) Premium Butyl Rubber Sealant (300ml) 1L Polymer Solvent Free Primer
---------	--



www.thermopanel.co.uk ■ mail@thermopanel.co.uk ■ t: 01394 593 110

Unit 16, Martlesham Creek Ind Est, Sandy Lane,
Woodbridge, Suffolk. IP12 4SD